

# User Manual

## Hand Held Metal Detector

### ZK-D300

Version: 2.0

Date: November 2018

## 1. Diagram

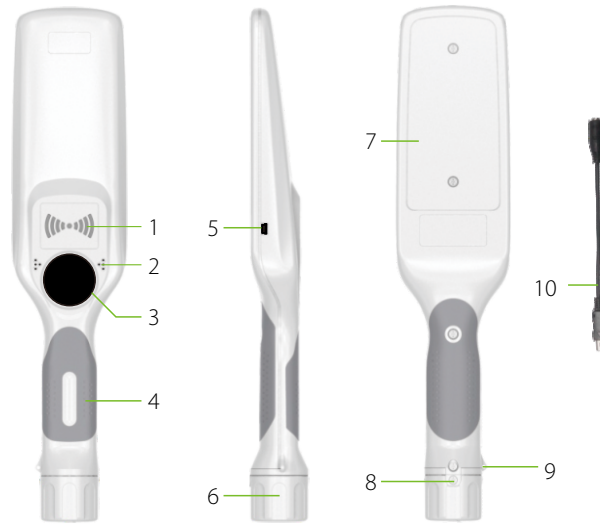

1. Indicator (alarm, charging, low battery, etc.)
2. Volume hole
3. Key combination
4. Handle
5. USB port
6. Battery cover
7. Detection area
8. Battery cover screw
9. Hole for hanging rope
10. Conversion cable of USB and 3.5mm headphone jack

## 2. Keys and Operation Instructions

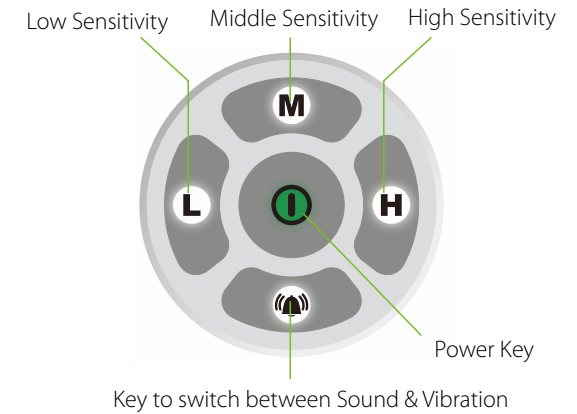

This detector has illuminated keys, which indicates its working state.

**Power Key:** Long press to power on, and in working state long press it to power off. The power indicator flashes once in every 3 seconds in working state.

**Sensitivity Key:** The sensitivity is divided into 4 levels; low, medium, high, and super high. Select low, medium or high sensitivity by pressing the corresponding sensitivity key, the corresponding indicator flashes once in every 3 seconds. To switch to super high sensitivity, select a sensitivity, and press the sensitivity key again. Three sensitivity indicators won't flash.

**Sound & Vibration key:** Press this key to switch between "Sound" > "Vibration" > "Sound and Vibration" mode. When the indicator doesn't flash, it indicates sound and light alarm mode. When it flashes once in every 3 seconds, it indicates the vibration and light alarm mode. When it flashes once every 1.5 seconds, it indicates the sound, vibration and light alarm mode.

### 3. Features

1. Digital design and strong anti-interference ability.
2. Easy to use and carry.
3. High sensitivity. There are three kinds of detection modes: Magnetic metal detection mode, Non-magnetic metal detection mode, and Mixed mode.
4. Sound and light alarm, connects to external earphone.
5. Three alarm modes: Vibration, Sound, vibration and sound.
6. Uses No. 5 battery type which is easily available, and can work continuously for more than 100 hours. (Pay attention to the positive and negative poles while installing the battery).
7. In standby state for more than 2 minutes, it will sleep automatically, and in case of more than 10 minutes of inactivity, it will shut down. Press any button or take it close to any metal to activate it.
8. Two charging methods: Direct charging and Seat charging (Please use only rechargeable battery). It has charging and low-power indicators.

### 4. Indicator Instructions

**Alarm indicator:** The intensity is divided into 3 levels. The larger the metal is, or the closer it is to the metal, the higher the alarm level is.



**Charging Indicator:** It gives progressive indication while charging as shown below. The light will go off when the battery is full charged.



**Low Battery Indicator:** The centre light flashes quickly when the power is low.

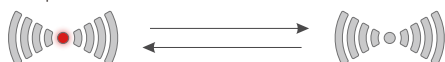

### 5. Main Parameters

**Size:** 360x82.5x42.5mm      **Weight:** 270g

**Power Supply:** Two No.5 batteries, standard rechargeable batteries.

**Charger:** General 5V USB direct charging (Mobile phone charging head, computer USB port, etc); No.5 Ni-MH battery charger

**Power Consumption:** <60mW

**Material:** The cover is mainly ABS and rubber.

**Operating Temperature:** -25°C~+60°C (Relative Humidity: 0~95%)

ZKTeco Dongguan Industrial Park, No. 26, Pingshan 188,  
Tangxia, Dongguan, China

Email: [sales@zkteco.com](mailto:sales@zkteco.com)  
[www.zkteco.com](http://www.zkteco.com)

